

**CLAYTON OFF ROAD
COR-1206104
JEEP GRAND CHEROKEE CONTROL ARM SPACER KIT (1999-2004 WJ)**

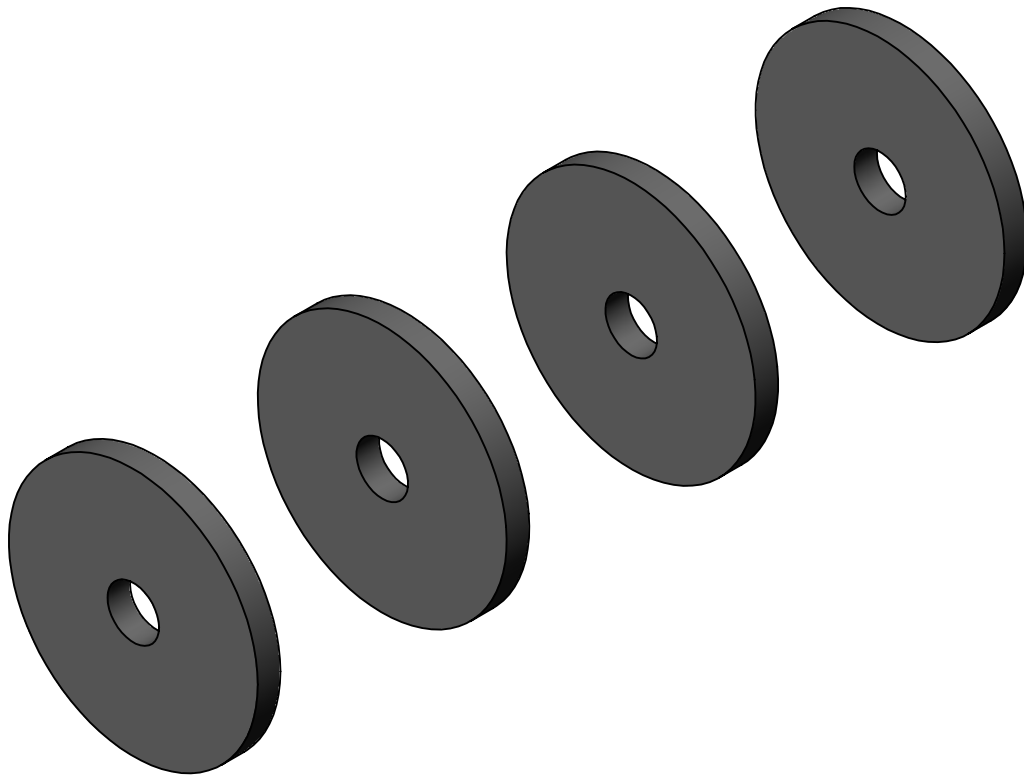

NOTES: This product may require general welding, fabrication and automotive mechanic skills. Welding should only be done by a competent welder. Clayton Off Road implies no guarantees or warranties and is not liable for improper installation. Some grinding and fitment may be required when installing this product. Every vehicle varies slightly and some fabrication may be required.

For more information please visit our website.

Refer to pictures below and drawing views.

Step 1: Remove stock control arm.

Step 2: Bolt new control arm and spacers into control arm bracket.

Step 3: Tack weld spacers to bracket.

Step 4: Remove new control arm.

Step 5: Weld spacer to bracket. Three one inch beads ar enough.

Step 6: Paint axle bracket.

Step 7: Install new control arm.



