

**CLAYTON OFF ROAD
COR-2910001
JEEP GLADIATOR 1.5" LEVELING KIT (2020 & UP, JT)**

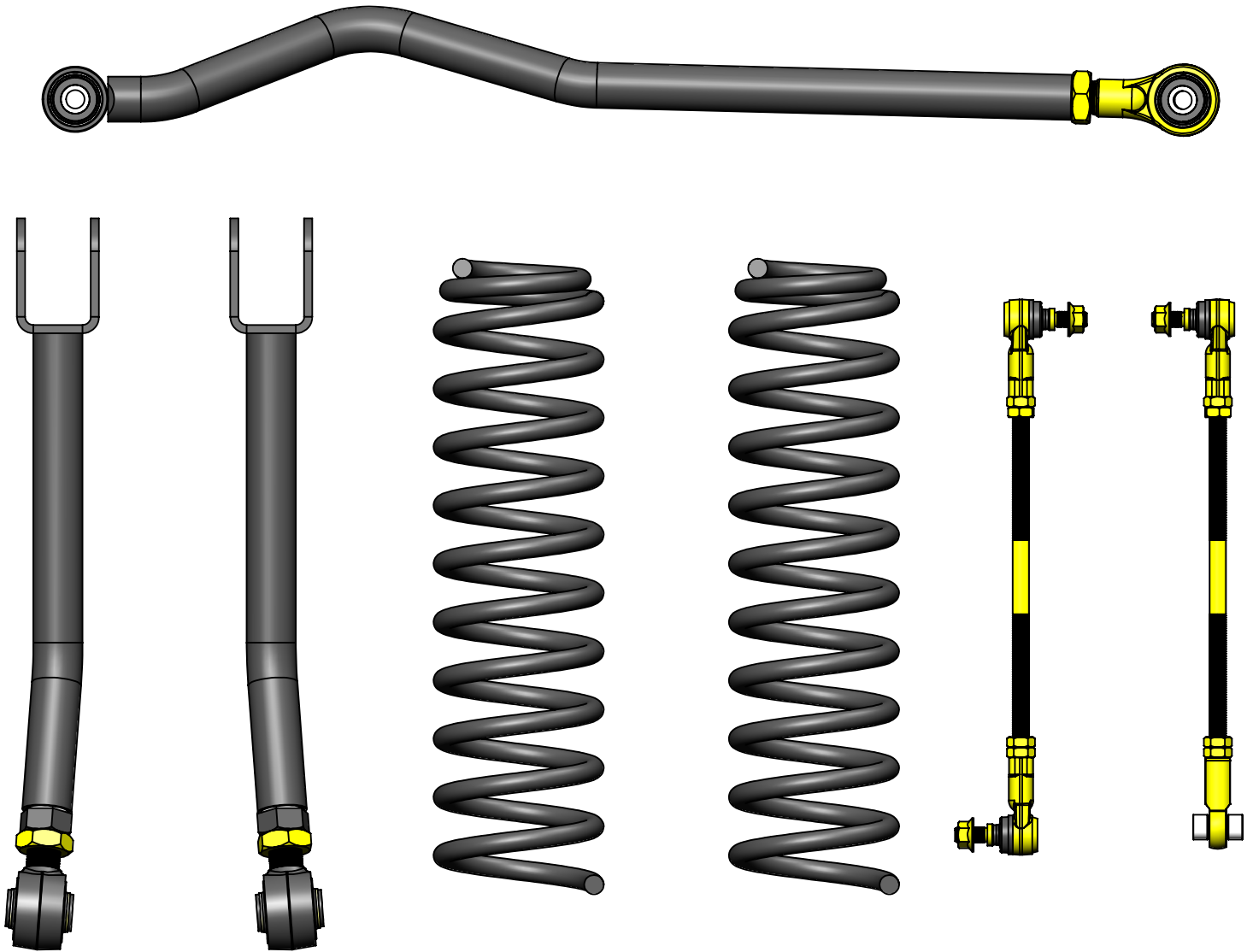

NOTES: This product may require general welding, fabrication and automotive mechanic skills. Welding should only be done by a competent welder. Clayton Off Road implies no guarantees or warranties and is not liable for improper installation. Some grinding and fitment may be required when installing this product. Every vehicle varies slightly and some fabrication may be required. For more information please visit our website.

Recommended starting lengths for track bars and control arms. These lengths can be adjusted as needed for caster angle, drive shaft angles and tire clearance. Please make sure to not exceed the maximum length of the control arms or track bars.

Lift Height >	Stock	1.5" Leveling Kit	2.5" Lift	3.5" Lift	2.5" RR	3.5" RR
Suspension Component						
Front Lower Control Arms	24.000	NA	24.336	24.500	NA	NA
Front Upper Control Arms	20.185	20.000	20.272	20.401	19.937	19.812
Rear Lower Control Arms	23.740	NA	23.962	24.116	NA	NA
Rear Upper Control Arms	16.378	NA	16.577	16.759	NA	NA
Front Track Bar	33.779	33.958	34.090	34.251	34.09	34.251
Rear Track Bar	33.689	NA	33.869	33.987	33.869	33.987

Refer to individual product part number instructions.

Step 1: Position front of vehicle on jack stands or complete vehicle on lift.

Step 2: Support front axle.

Step 3: Remove front tires.

Step 4: Loosen front track bar bolts.

Step 5: Remove heat shields and loosen upper and lower control arm bolts.

Step 6: Loosen front upper and lower control arm bolts.

Step 7: Remove front sway bar links.

Step 8: Remove front shocks.

Step 9: Remove two brake line clip bolts on both sides.

Step 10: Unclip and disconnect all wires going to the front axle.

Step 11: Lower front axle.

Step 12: Remove front springs.

Step 13: Remove front upper arm on one side.

Step 14: Install front upper control arm part number COR-1709101 with curve away from the frame.

Step 15: Repeat steps 13 and 14 on other side.

Step 16: Remove front track bar.

Step 17: Install front track bar part number COR-4509100.

Step 18: Install front springs part number COR-1508250.

Step 19: Install front shocks.

Step 20: Install front sway bar links part number COR-5109100.

Step 21: Clip and connect all wires going to the front axle.

Step 22: Install front tires.

Step 23: With vehicle sitting at ride height center front axle under the vehicle by adjusting the front track bar.

Step 24: The next 2 steps are very important to set the caster. Use a jack to remove the load on the bolts at the frame end of the arm. Adjust the height of the jack to set your caster angle. Caster should be between 4.5 and 5.5 degrees.

Step 25: Adjust length of front upper arms so that the bolts easily go in mounting brackets.

Step 26: Remove jack from axle.

Step 27: Tighten all track bar and control arm bolts.

Step 28: Tighten all track bar and control arm jam nuts.

**Clayton Off Road
COR-1709101
Jeep Overland + Front Upper Control Arms (2018 & Up, JL/JT)**



NOTES: This product may require general welding, fabrication and automotive mechanic skills. Welding should only be done by a competent welder. Clayton Off Road implies no guarantees or warranties and is not liable for improper installation. Some grinding and fitment may be required when installing this product. Every vehicle varies slightly and some fabrication may be required. For more information please visit our website.

Refer to pictures below.

Step 1: Support axle from rotating, a floor or bottle jack works well.

Step 2: Remove old control arms.

Step 3: Set caster to 4.5 to 5.5 degrees by adjusting the height of the jack.

Step 4: Install arms at frame side, arm should bow away from frame.

Step 5: Adjust control arm to length so that bolts can easily be installed at axle end.

Step 6: Remove jack, and check caster.

Step 7: Torque all bolts to 80 ft-lb.

Step 8: Tighten jam nut using a 1-7/16" wrench

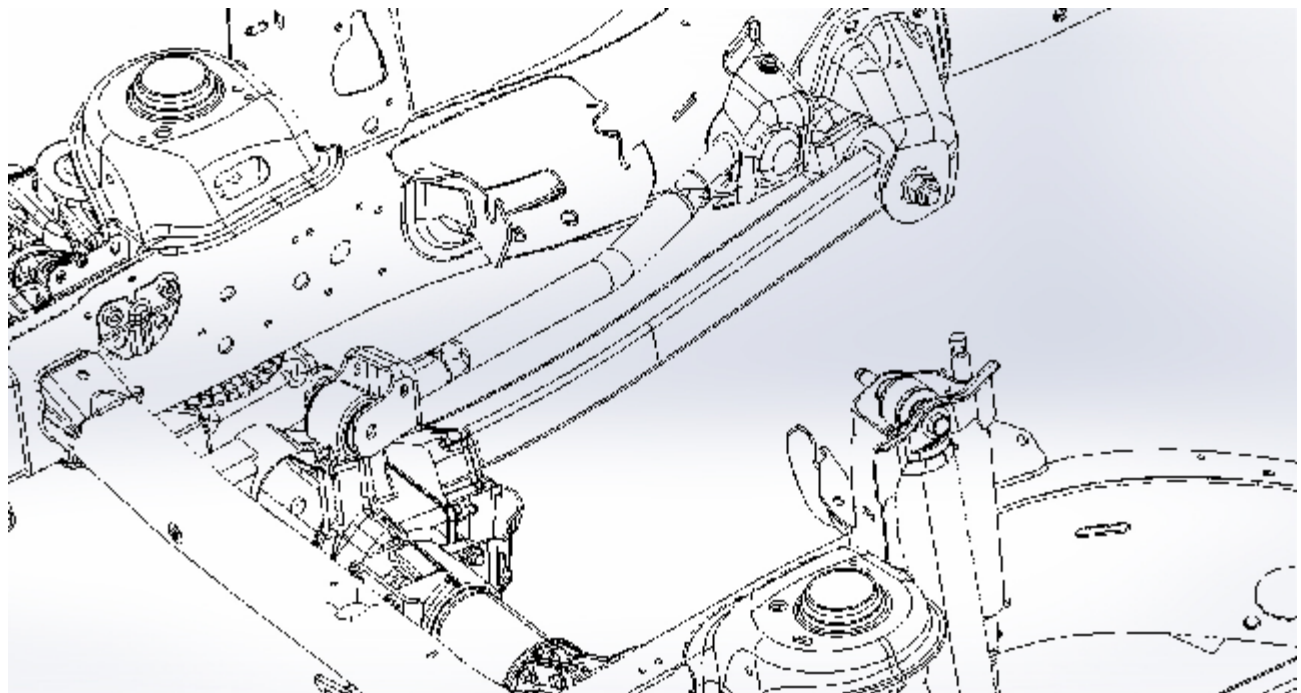
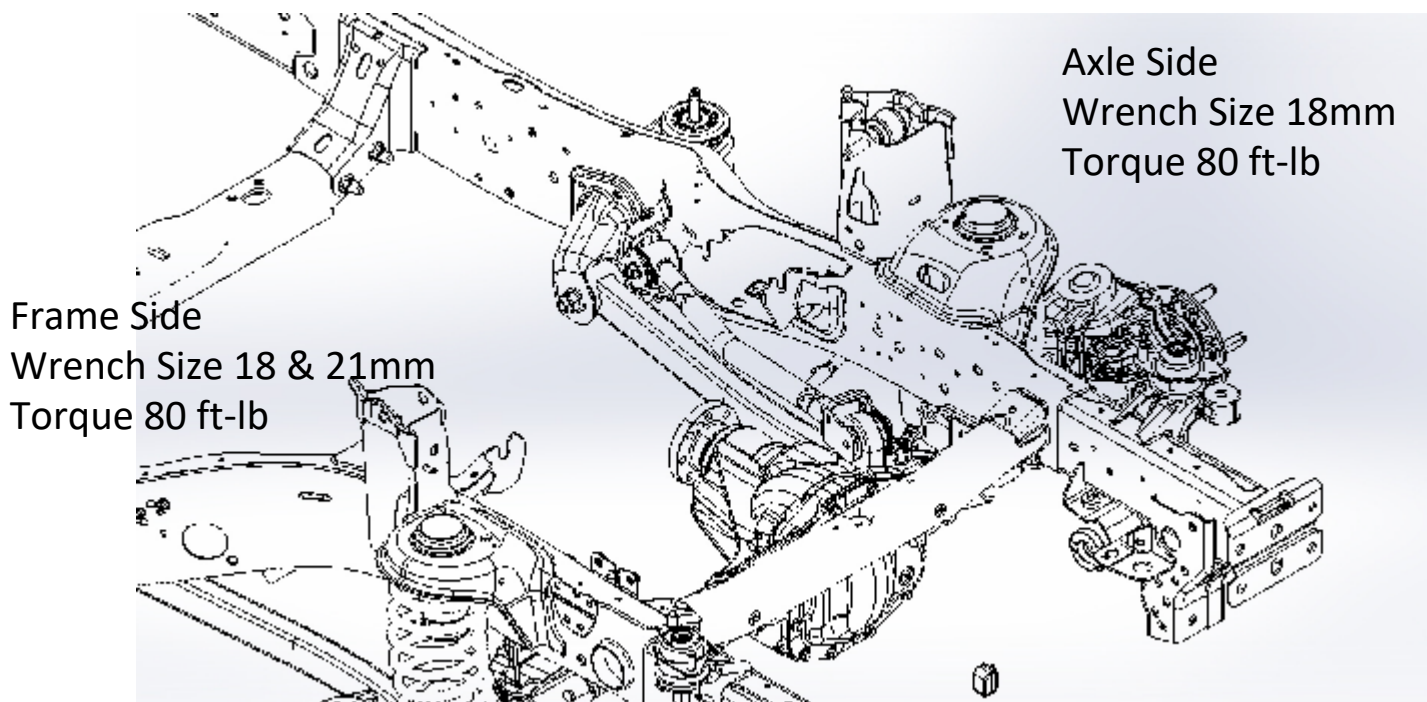

Refer to drawing below for minimum and maximum lengths.

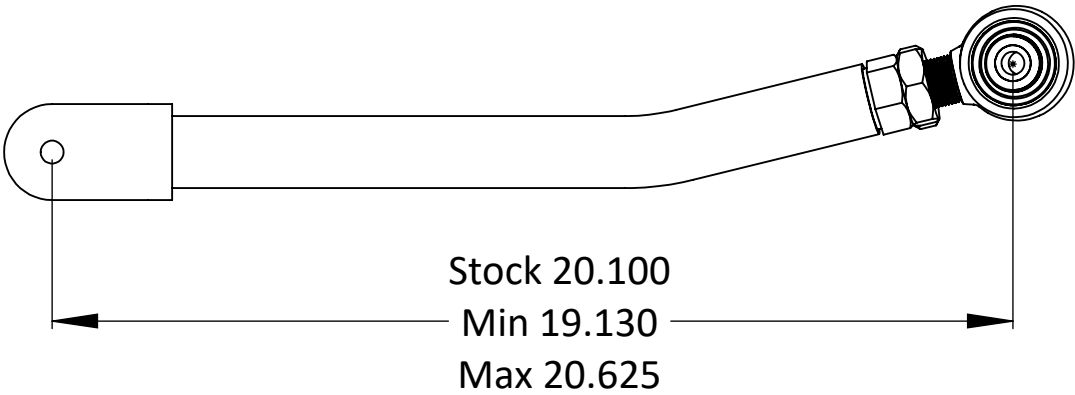

**Clayton Off Road
COR-4509100
Jeep Adjustable Front Track Bar (2018 & Up, JL/JT)**

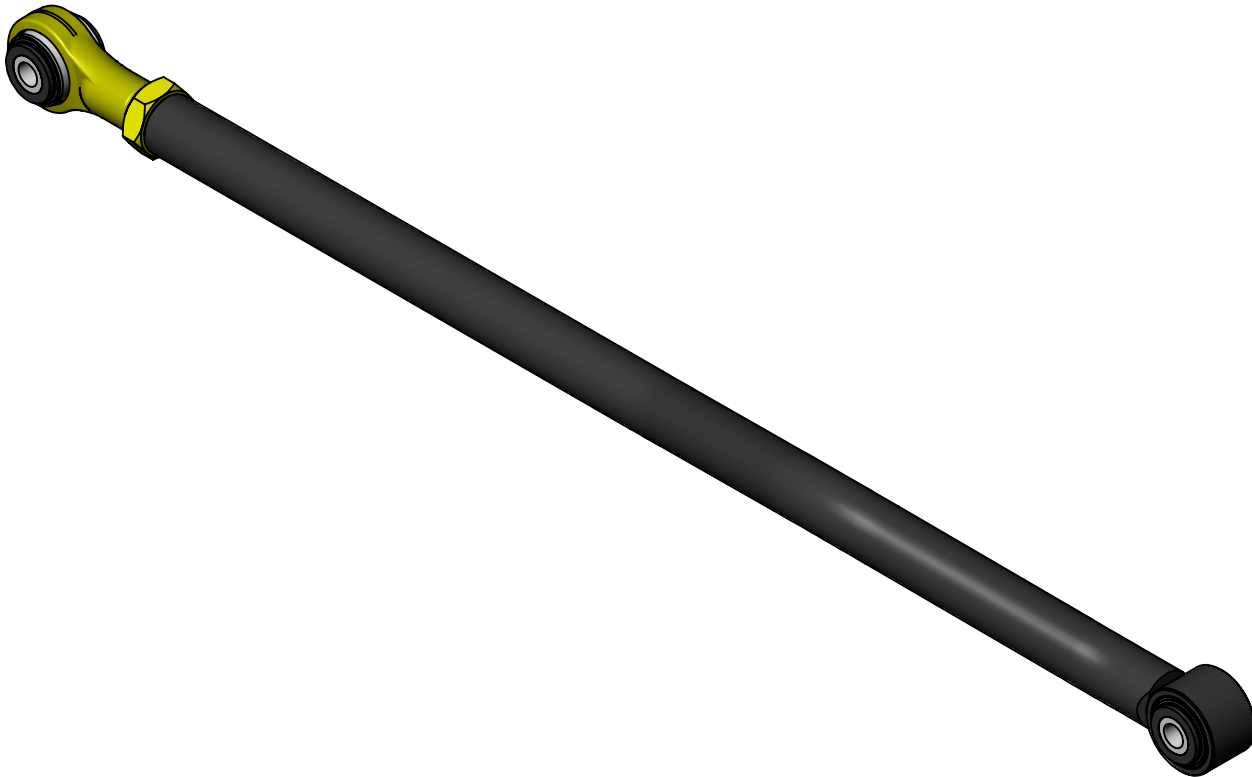

NOTES: This product may require general welding, fabrication and automotive mechanic skills. Welding should only be done by a competent welder. Clayton Off Road implies no guarantees or warranties and is not liable for improper installation. Some grinding and fitment may be required when installing this product. Every vehicle varies slightly and some fabrication may be required. For more information please visit our website.

Refer to pictures below.

Step 1: Remove old track bar.

Step 2: Center frame on axle.

Step 3: Measure length from axle side mount to frame side mount.

Step 4: Adjust track bar to length and run jam nut up to track bar tube.

Step 5: Install new track bar with adjustment end on axle.

Step 6: Install track bar bolts and nuts.

Step 7: Torques both bolts to 110 ft-lb.

Step 8: Tighten jam nut using a 1-7/16" wrench.

Step 9: Make sure Johnny Joint at frame side is centered in bracket.

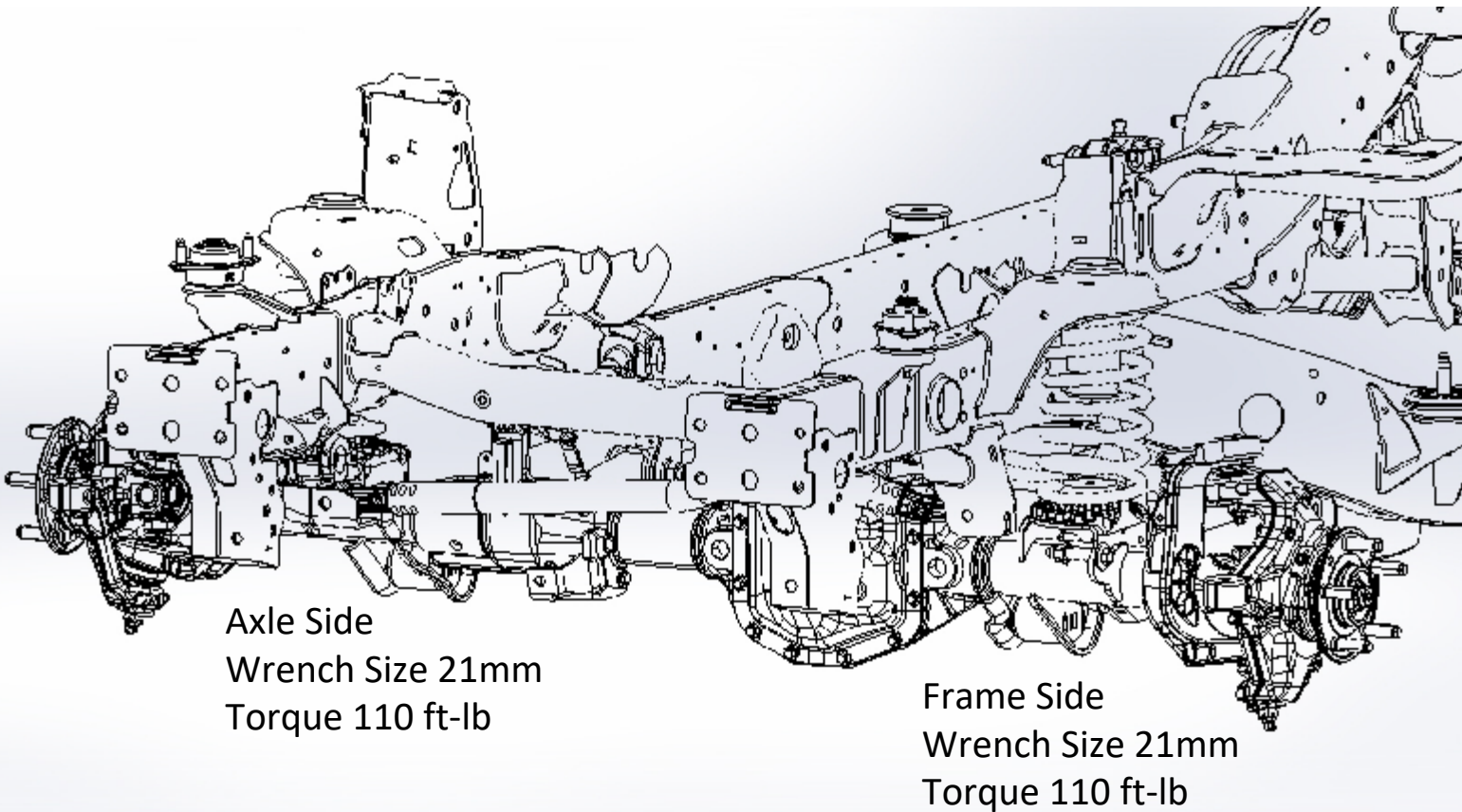

Refer to drawing below for minimum and maximum lengths.

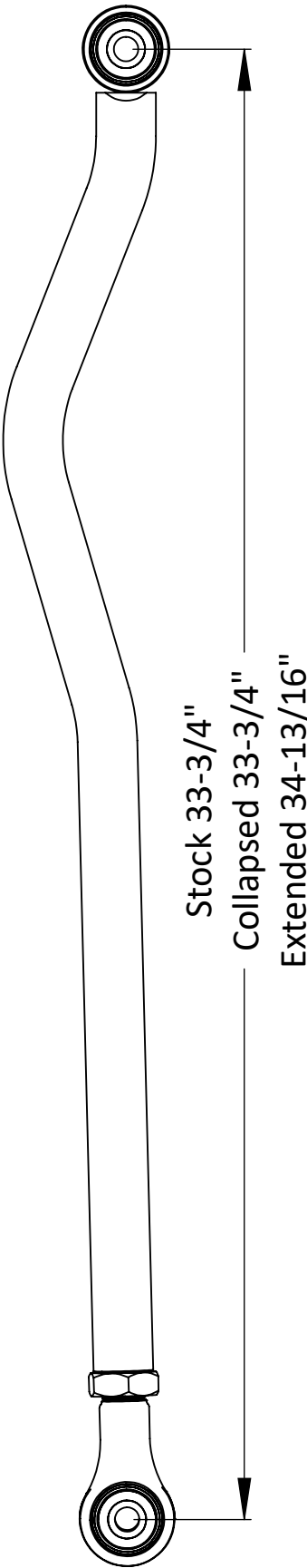

**Clayton Off Road
COR-5109100
Jeep Adjustable Front Sway Bar End Links (2018 & Up, JL/JT)**

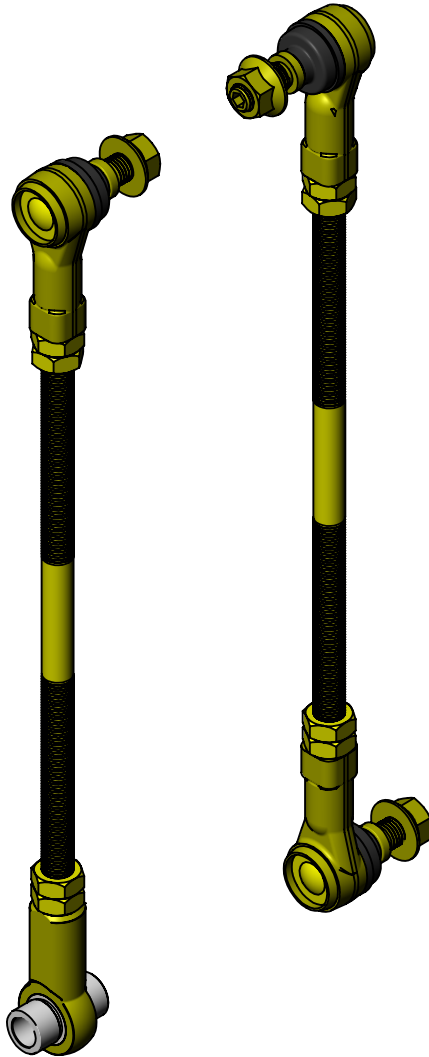

NOTES: This product may require general welding, fabrication and automotive mechanic skills. Welding should only be done by a competent welder. Clayton Off Road implies no guarantees or warranties and is not liable for improper installation. Some grinding and fitment may be required when installing this product. Every vehicle varies slightly and some fabrication may be required. For more information please visit our website.

Refer to pictures below.

Step 1: Remove old sway bar end links.

Step 2: Make sure vehicle is at ride height.

Step 3: Refer to the spread sheet below to determine how much to cut from each end of threaded rod.

Step 4: Cut threaded rod.

Step 5: Deburr end of threaded rod.

Step 6: Install two jam nuts on each end of rod. Use one jam nut on each end if it needs to be shorter.

Step 7: It maybe necessary to lock the 2 jam nuts against each other to thread rod end on.

Step 8: The rod end with no stud in it goes on the passenger side axle, Use a aluminum spacer on each side of this rod end.

Step 9: Install sway bar links with the upper studs facing inward and the lower driver side facing out.

Step 10: Make sure all rod ends are centered.

Step 11: Torque all nuts, bolts and jam nuts to 60 ft-lb.

Step 12: Cycle the suspension through its full travel, check for binding and adjust rod length if needed.

Step 13: Do not exceed maximum length.

Step 14: Make sure to keep at least 3/4" of thread engagement with rod end.

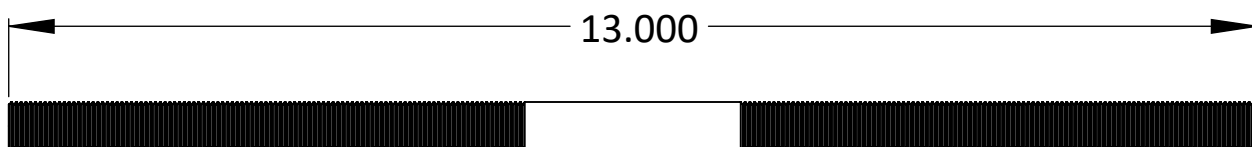

Lift Height > Component	Stock	1.5" Lift		2.5" Lift		3.5" Lift		4.5" Lift	
		Center Length	Cut Each End	Center Length	Cut Each End	Center Length	Cut Each End	Center Length	Cut Each End
JK Front Sway Bar Link	5.250	8.250	3.438	9.250	2.938	10.250	2.438	11.250	1.938
JK Rear Sway Bar Link	8.750	10.750	2.188	11.750	1.656	12.750	1.188	13.750	0.688
JL Front Sway Bar Link	5.063	8.063	3.531	9.063	3.000	10.063	2.531		
JL Rear Sway Bar Link	8.750	10.750	2.188	11.750	1.656	12.750	1.188		
JT Front Sway Bar Link	5.063	7.063	4.031	8.063	3.500	9.063	3.031		
JT Rear Sway Bar Link	10.625	12.625	1.250	13.625	0.719	14.625	0.250		

Refer to drawing below for minimum and maximum lengths.

