

Clayton Off Road
COR-5109100
Jeep Wrangler Adjustable Front Sway Bar End Links (2018 & Up, JL)

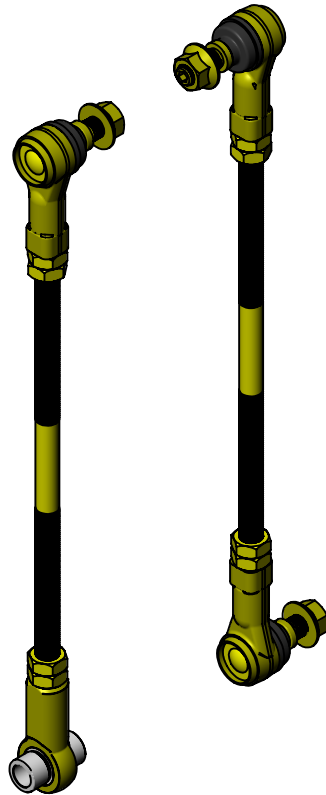

NOTES: This product may require general welding, fabrication and automotive mechanic skills. Welding should only be done by a competent welder. Clayton Off Road implies no guarantees or warranties and is not liable for improper installation. Some grinding and fitment may be required when installing this product. Every vehicle varies slightly and some fabrication may be required.

For more information please visit our website.

Refer to pictures below.

Step 1: Remove old sway bar end links.

Step 2: Make sure vehicle is at ride height.

Step 3: Refer to the spread sheet below to determine how much to cut from each end of threaded rod.

Step 4: Cut threaded rod.

Step 5: Deburr end of threaded rod.

Step 6: Install two jam nuts on each end of rod. Use one jam nut on each end if it needs to be shorter.

Step 7: It maybe necessary to lock the 2 jam nuts against each other to thread rod end on.

Step 8: The rod end with no stud in it goes on the passenger side axle, Use a aluminum spacer on each side of this rod end.

Step 9: Install sway bar links with the upper studs facing inward and the lower driver side facing out.

Step 10: Make sure all rod ends are centered.

Step 11: Torque all nuts, bolts and jam nuts to 60 ft-lb.

Step 12: Cycle the suspension through its full travel, check for binding and adjust rod length if needed.

Step 13: Do not exceed maximum length.

Step 14: Make sure to keep at least 3/4" of thread engagement with rod end.

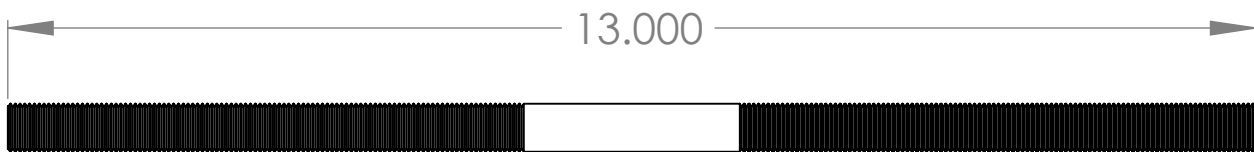

Lift Height >	Stock	1.5" Lift		2.5" Lift		3.5" Lift		4.5" Lift	
Suspension Component		Center Length	Cut Each End	Center Length	Cut Each End	Center Length	Cut Each End	Center Length	Cut Each End
JK Front Sway Bar Link	5.250	8.250	3.438	9.250	2.938	10.250	2.438	11.250	1.938
JK Rear Sway Bar Link	8.750	10.750	2.188	11.750	1.656	12.750	1.188	13.750	0.688
JL Front Sway Bar Link	5.063	8.063	3.531	9.063	3.000	10.063	2.531		
JL Rear Sway Bar Link	8.750	10.750	2.188	11.750	1.656	12.750	1.188		
JT Front Sway Bar Link	5.063	7.063	4.031	8.063	3.500	9.063	3.031		
JT Rear Sway Bar Link	10.625	12.625	1.250	13.625	0.719	14.625	0.250		

Refer to drawing below for minimum and maximum lengths.

